

**UNIVERSITY OF WASHINGTON
UW FACILITIES, ASSET MANAGEMENT**

DATE: March 14, 2022

SUBJECT: SEPA Categorical Exemption

Per RCW 43.21C, WAC 197-11 and WAC 478-324-020 through 210, the University of Washington (UW) is the Lead Agency responsible for compliance with the State Environmental Policy Act (SEPA) for projects which the University initiates. Public notice of categorical exemptions is not required per WAC 197-11-305(2) which states “an agency is not required to document that a proposal is categorically exempt.” Agencies may note on an application that a proposal is categorically exempt or place such a determination in agency files.

NAME: ASUW Shell House Waterline Repair

LOCATION: UW Seattle Campus

HISTORY: The project identifies an existing waterline that is undersized and two outdated fire hydrants that require repair.

PROJECT DESCRIPTION: The project will replace a waterline and two fire hydrants. The waterline and hydrants provide water for fire suppression to the ASUW Shell House. Replacement waterworks would consist of 20 feet of Class 52 6-inch ductile iron pipe and 160 feet of DR 11 HDPE pipe as well as gate valves, fittings, fire hydrants and thrust blocks. The trench area for the work would be approximately 180-feet long by 2-feet wide by 4-feet deep or approximately 53 cubic yards. The location of the trench is in the footprint of an existing asphalt pathway that is in disrepair. Restoration of the trenched area would include a new asphalt pathway and landscape restoration.

The work area is outlined in red in the map at right. A small portion of the E-12 Parking Lot outlined in yellow would be temporarily closed to stage materials and vehicles.

The work is anticipated to begin in March 2022 with trenching and pathway restoration complete by early May. Landscape restoration may continue through May 2022.



CONTROL MEASURES:

Environmental Best Management Practices (BMPs) for temporary erosion and sedimentation control per UW Facilities Design Standards include the following:

1. Snow fence will be installed for tree and landscape protection.
2. Catch basins within work area drainage will be fitted with filter socks as denoted with red circled green squares in **Figure 1**.
3. Areas of disruption will mostly be limited to existing hardscape footprints. Minor alteration to adjacent landscaping may occur.
4. The asphalt will be pre-cut and removed at the south downhill termination of the pathway and surrounded with staked straw wattles as shown in **Figure 1** to capture runoff.
5. Rainwater in the trench will be pumped through filter fabric into containers for discharge into the sanitary sewer with a soil/water separator in UW Corp Yard 1 or dispersed into vegetation with sufficient area and flow rate for onsite infiltration. Rainwater may also be pumped into a Baker tank and/or removed by vacuum truck. Trenches may also be covered to minimize rainwater collection.
6. Vehicle tires, tracks and implements will be cleaned in the work area before moving into adjacent hardscape areas to remain. Sediments will be removed from hardscape areas including the staging area will be cleaned of sediments.
7. Excavated soils will be loaded in the pathway footprint, transported to Corp Yard 2 by dump truck, and removed from the site by a vendor. Suitable excavated soils will be used for backfill. Staged topsoil for restoration will be covered by weighted tarps.
8. Following construction, all hardscapes will be cleaned and catch basin filter socks will be removed.

SEPA DETERMINATION: This project is categorically exempt per WAC 197-11-800(3) of the State Environmental Policy Act. This section exempts repair, remodeling, maintenance or minor alteration of existing private or public structures, facilities or equipment, including utilities, involving no material expansions or changes to the existing use. No adverse environmental impacts are associated with this project.

Figure 1 – ASUW Shell House Waterline repair details (next page).

2022 ASUW Shell House Waterline Repair

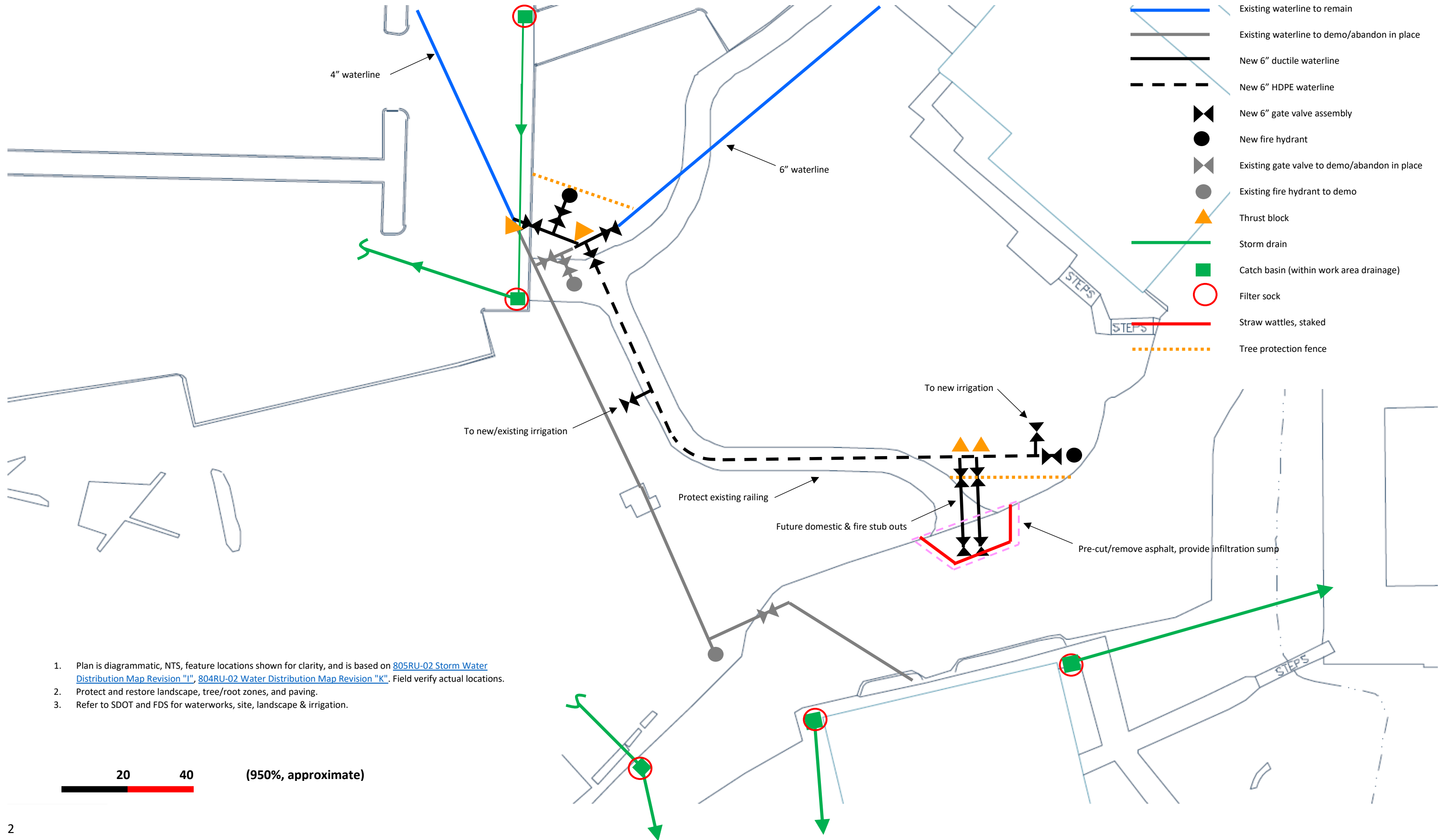

1. Plan is diagrammatic, NTS, feature locations shown for clarity, and is based on [805RU-02 Storm Water Distribution Map Revision "I"](#), [804RU-02 Water Distribution Map Revision "K"](#). Field verify actual locations.
2. Protect and restore landscape, tree/root zones, and paving.
3. Refer to SDOT and FDS for waterworks, site, landscape & irrigation.

20
 40
 (950%, approximate)