



## INTERCOLLEGIATE ATHLETICS BASKETBALL TRAINING FACILITY

### PROJECT CONTACTS

Sydney Thiel  
*Project Manager*  
 Project Delivery Group  
 sydthiel@uw.edu | 206.960.2417



Bob Dillon  
*Construction Project Manager*  
 Project Delivery Group  
 bdillon@uw.edu | 206.423.5155



### ABOUT THE PROJECT

- 36,000 sf (new facility) + 4,000 sf (interior renovation) = 40,000 sf total project
- 2 stories in height (approximately 40')
- Supports Men's and Women's Basketball programs
- Direct Connections to Hec Ed and Graves Annex for all athletes



CLICK OR SCAN TO LEARN MORE

### SUMMARY OF UPCOMING ACTIVITIES (November 15 - December 31, 2024)

The project has been continuing with its underground foundation work, placing concrete pile caps/grade beams and starting the install of the underground plumbing and foundation drainage. Throughout the next month, the pile caps will be fully installed, underground electrical and methane venting pipe install will start and the retaining walls at the West and South ends will be placed through a shotcrete method. You will continue to see concrete trucks and more material arrive on site as the team gets prepared for the slab on grade work, which occurs at the end of December.

### IMPACT BULLETIN

IMPACT TYPE	INFORMATION	IMPACT DATES
NOISE	<ul style="list-style-type: none"> <li>• Shotcrete Retaining Walls</li> </ul>	<ul style="list-style-type: none"> <li>• Nov 18 2024 - Dec 13 2024</li> </ul>
MINOR VIBRATION	<ul style="list-style-type: none"> <li>• Tie-In at Hec Ed</li> </ul>	<ul style="list-style-type: none"> <li>• Nov 26 2024</li> </ul>
CLOSURES/ TRANSPORT	<ul style="list-style-type: none"> <li>• Pedestrian walk/bike path re-routed by Nordstrom</li> </ul>	<ul style="list-style-type: none"> <li>• Mar 1 - Aug 2025</li> </ul>

### UPCOMING MILESTONES



- *November 19: Shotcrete Begins*
- *November 25: Underslab Electrical Starts*







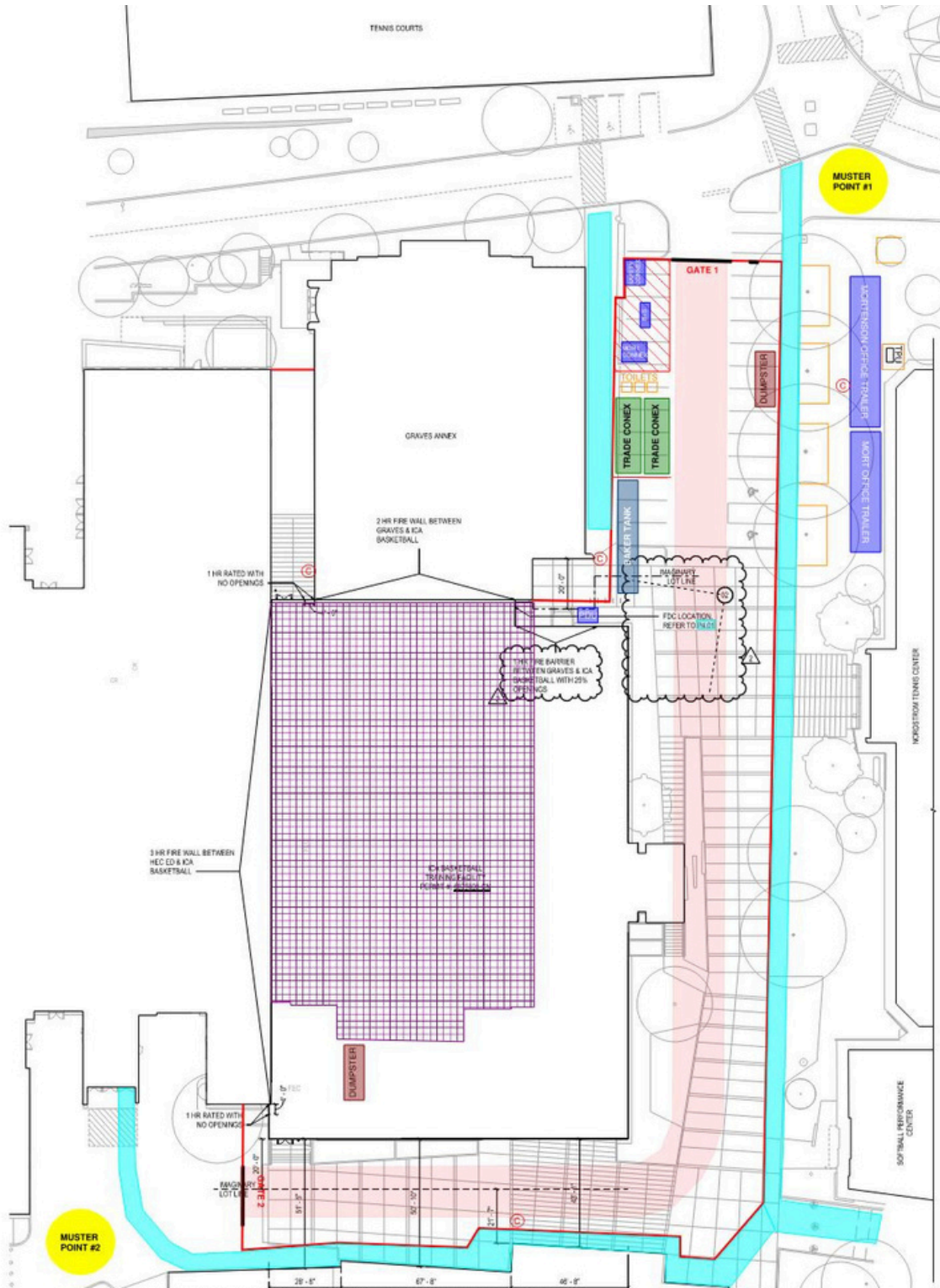

- *December 13: Slab on Grade Activities Start*

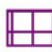
# SITE LOGISTICS (STANDARD)

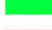

## Site Logistics Legend

-  Existing Building Footprint
-  Pedestrian Walk Path
-  Bike Path
-  Site Fence
-  Fire Lane
-  Office Trailers