



INTERCOLLEGIATE ATHLETICS BASKETBALL TRAINING FACILITY

PROJECT CONTACTS

Sydney Thiel
Project Manager
 Project Delivery Group
 sydthiel@uw.edu | 206.960.2417



Bob Dillon
Construction Project Manager
 Project Delivery Group
 bdillon@uw.edu | 206.423.5155



ABOUT THE PROJECT

- 36,000 sf (new facility) + 4,000 sf (interior renovation) = 40,000 sf total project
- 2 stories in height (approximately 40')
- Supports Men's and Women's Basketball programs
- Direct Connections to Hec Ed and Graves Annex for all athletes



CLICK OR SCAN TO LEARN MORE

SUMMARY OF UPCOMING ACTIVITIES (October 15 - November 30, 2024)

The majority of the site excavation is completed and the lagging/shoring system is now in place. The next month will consist of work at the bottom of the building. This includes finishing the deep ACIP (Auger Cast In Place) piles, placing our concrete foundation pile caps and grade beams, and installing underground MEP to prepare for the placement of the slab on grade. You will continue to see excavators on site as well as concrete mix trucks for the next couple months. Additionally, the site fence will continue to periodically be pulled in during home games as the UW football season continues.

IMPACT BULLETIN

IMPACT TYPE	INFORMATION	IMPACT DATES
NOISE	<ul style="list-style-type: none"> • Foundation Pile Drilling • Installing Pile Caps & Grade Beams • Shotcrete Retaining Walls 	<ul style="list-style-type: none"> • Oct 08 - Oct 18 • Oct 18 - Dec 03 • Nov 19 - Dec 13
MINOR VIBRATION	<ul style="list-style-type: none"> • Foundation Pile Drilling 	<ul style="list-style-type: none"> • Oct 08 - Oct 18
CLOSURES/ TRANSPORT	<ul style="list-style-type: none"> • Pedestrian walk/bike path re-routed by Nordstrom 	<ul style="list-style-type: none"> • Mar 1 - Aug 2025

UPCOMING MILESTONES



- *October 08: Deep Foundations Install Starts*
- *October 18: Install of Pile Caps Begins*

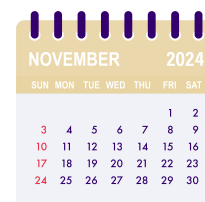





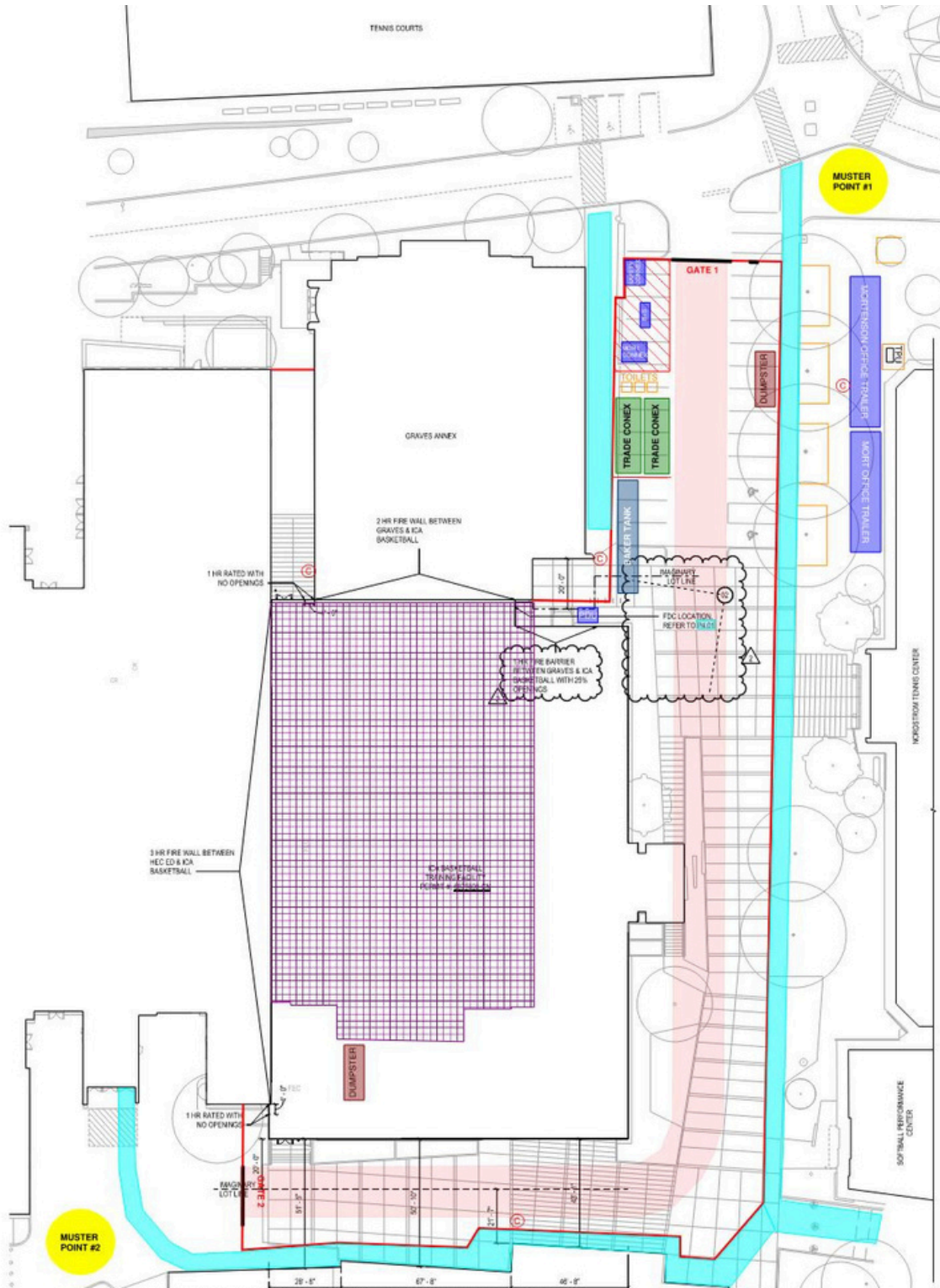

- *November 19: Shotcrete Begins*

SITE LOGISTICS (STANDARD)







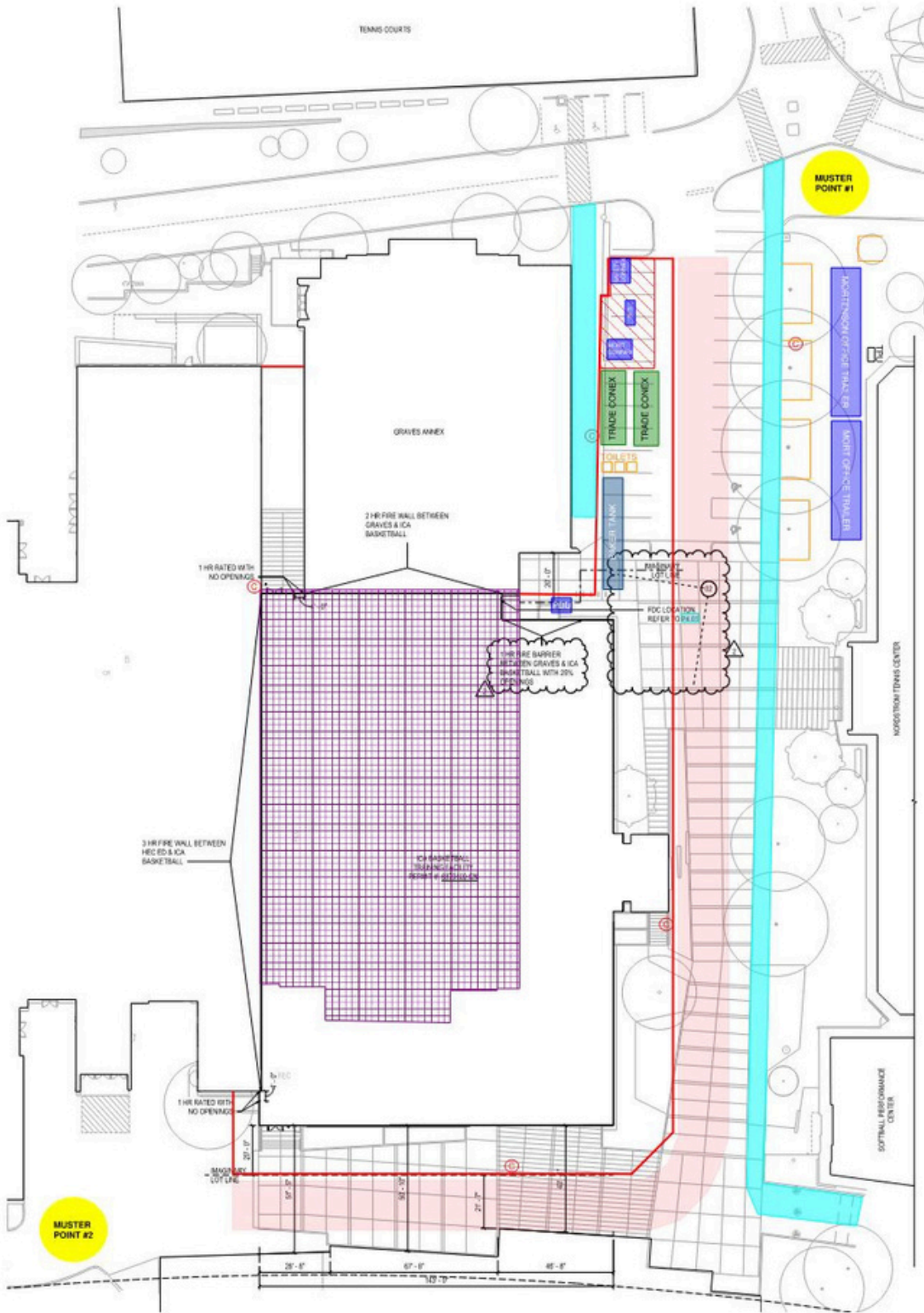

Site Logistics Legend

-  Existing Building Footprint
-  Pedestrian Walk Path
-  Bike Path
-  Site Fence
-  Fire Lane
-  Office Trailers

SITE LOGISTICS (FOOTBALL GAME DAY)



Site Logistics Legend

-  Existing Building Footprint
-  Pedestrian Walk Path
-  Bike Path
-  Fire Lane
-  Site Fence
-  Office Trailers