



INTERCOLLEGIATE ATHLETICS BASKETBALL TRAINING FACILITY

PROJECT CONTACTS

Sydney Thiel
Project Manager
 Project Delivery Group
 sydthiel@uw.edu | 206.960.2417



Bob Dillon
Construction Project Manager
 Project Delivery Group
 bdillon@uw.edu | 206.423.5155



ABOUT THE PROJECT

- 36,000 sf (new facility) + 4,000 sf (interior renovation) = 40,000 sf total project
- 2 stories in height (approximately 40')
- Supports Men's and Women's Basketball programs
- Direct Connections to Hec Ed and Graves Annex for all athletes



CLICK OR SCAN TO LEARN MORE

SUMMARY OF UPCOMING ACTIVITIES (September 15 - October 31, 2024)

The final soldier piles are being installed this week and the excavation and wood lagging process has started. The site will get deeper as the excavation commences and wood lagging will be installed between the piles to secure the soils outside the new building footprint. You will continue to see excavators and the crane on site in addition to a tieback drill rig that will occasionally produce a loud noise to drill in an anchor to support the shoring wall. The beginning/mid October will consist of similar looking equipment as the foundation piles are installed. Additionally, as the UW football season continues the site fence will be pulled in during home games for more pedestrian access.

IMPACT BULLETIN

IMPACT TYPE	INFORMATION	IMPACT DATES
NOISE	<ul style="list-style-type: none"> • Soldier Pile Drilling • Tieback Anchor Install • Foundation Pile Drilling 	<ul style="list-style-type: none"> • Aug 23 - Sept 20 • Sept 19 - Oct 01 • Oct 08 - Oct 23
MINOR VIBRATION	<ul style="list-style-type: none"> • Foundation Pile Drilling 	<ul style="list-style-type: none"> • Oct 08 - Oct 23
CLOSURES/ TRANSPORT	<ul style="list-style-type: none"> • Pedestrian walk/bike path re-routed by Nordstrom 	<ul style="list-style-type: none"> • Mar 1 - Aug 2025

UPCOMING MILESTONES





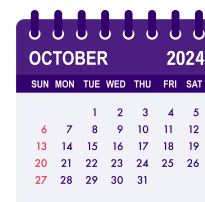

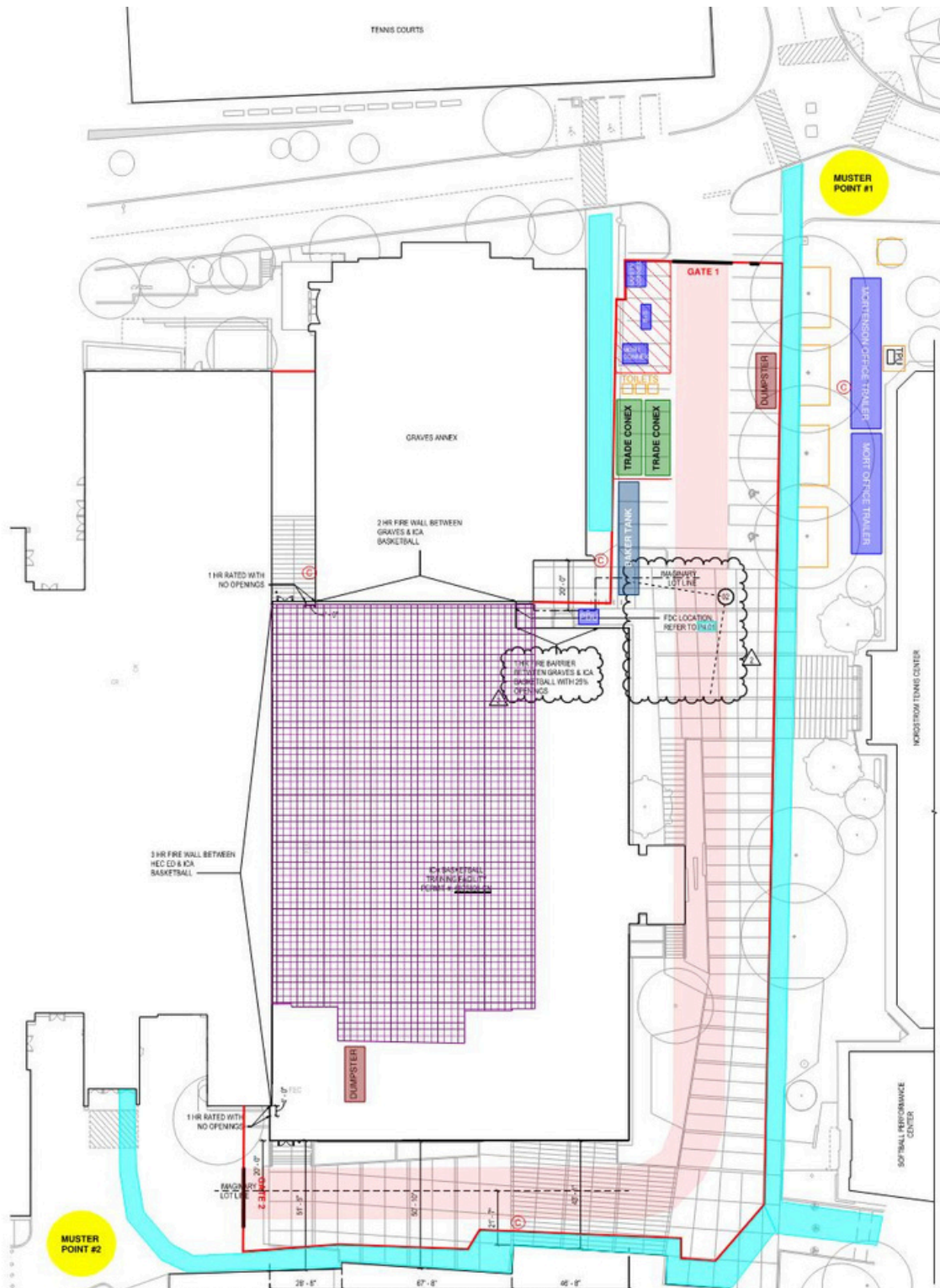

- *September 18: Lagging Starts*
- *September 19: Tieback Anchor Install Starts*



- *October 08: Deep Foundations Install Starts*



Site Logistics Legend

-  Existing Building Footprint
-  Pedestrian Walk Path
-  Bike Path
-  Fire Lane
-  Site Fence
-  Office Trailers