



INTERCOLLEGIATE ATHLETICS BASKETBALL TRAINING FACILITY

PROJECT CONTACTS

Sydney Thiel
Project Manager
 Project Delivery Group
 sydthiel@uw.edu | 206.960.2417



Bob Dillon
Construction Project Manager
 Project Delivery Group
 bdillon@uw.edu | 206.423.5155



ABOUT THE PROJECT

- 36,000 sf (new facility) + 4,000 sf (interior renovation) = 40,000 sf total project
- 2 stories in height (approximately 40')
- Supports Men's and Women's Basketball programs
- Direct Connections to Hec Ed and Graves Annex for all athletes



[CLICK OR SCAN TO LEARN MORE](#)

SUMMARY OF UPCOMING ACTIVITIES (August 15 - September 30, 2024)

The demo of the pool pavilion is complete and the project is getting ready to start the excavation and shoring phase of the project. You will start to see new pieces of equipment, such as a drilling rig and crane, come on site as the shoring phase of the project starts up. This will cause intermittent loud noise during the day as the piles are drilled down. You will also continue to see excavators and trucks on site as the utility work is finishing up and excavation is beginning. Additionally, as the UW football season officially starts, the site fence will pull in to give more space for pedestrian access.

IMPACT BULLETIN

IMPACT TYPE	INFORMATION	IMPACT DATES
NOISE	<ul style="list-style-type: none"> • Utility Demo • Soldier Pile Drilling • Tieback Anchor Install 	<ul style="list-style-type: none"> • Aug 14 - Aug 29 • Aug 23 - Sept 04 • Sept 11 - Sept 23
MINOR VIBRATION	<ul style="list-style-type: none"> • Soldier Pile Drilling 	<ul style="list-style-type: none"> • Aug 23 - Sept 04
CLOSURES/ TRANSPORT	<ul style="list-style-type: none"> • Pedestrian walk/bike path re-routed by Nordstrom 	<ul style="list-style-type: none"> • Mar 1 - Aug 2025

UPCOMING MILESTONES

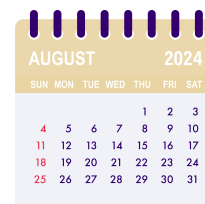





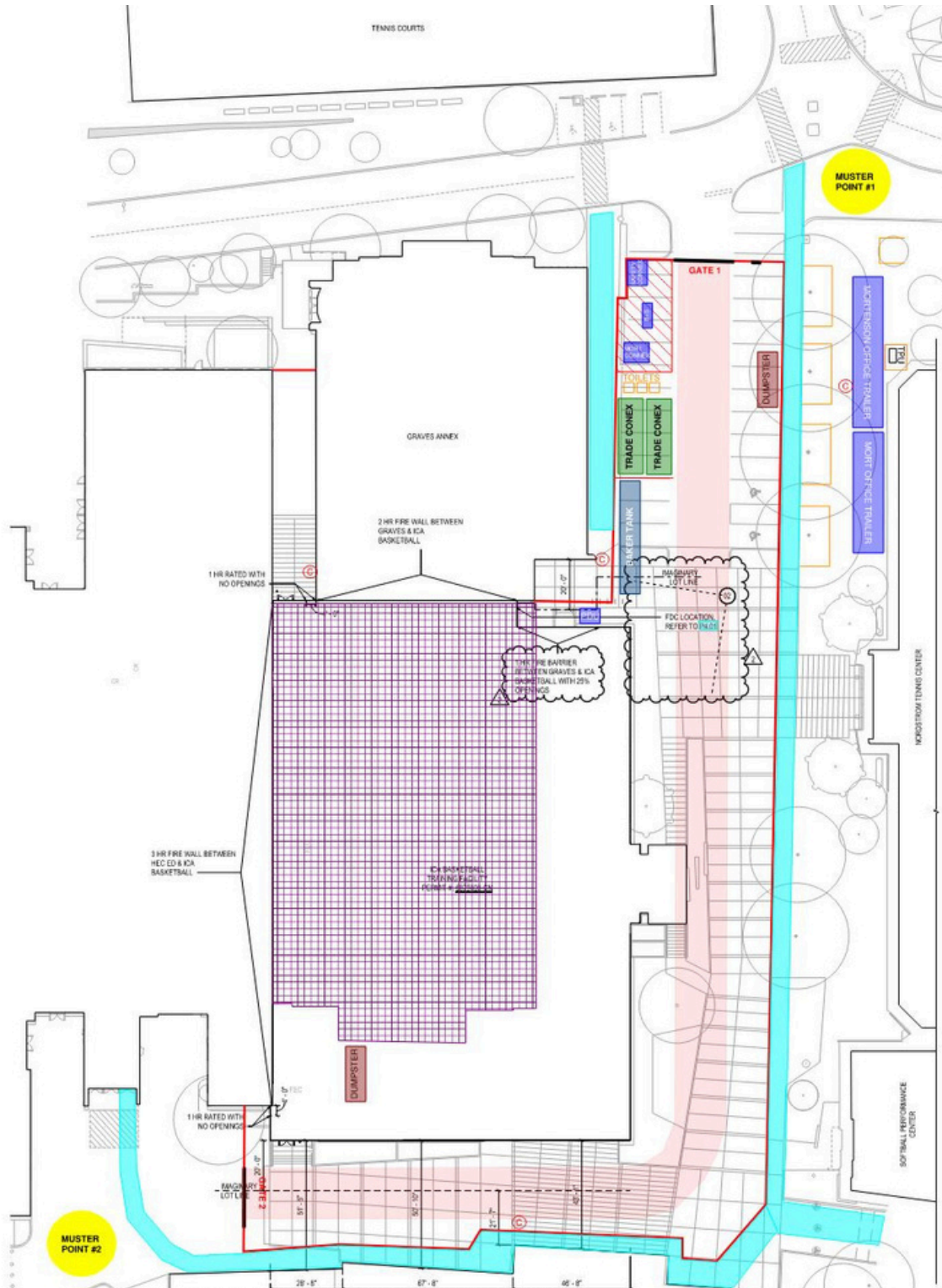

- *August 23: Soldier Pile Install Starts*
- *August 30: Mass Excavation Start*



- *September 11: Tieback Anchor Install Starts*
- *September 26: Deep Foundations Install Starts*



Site Logistics Legend

-  Existing Building Footprint
-  Pedestrian Walk Path
-  Bike Path
-  Fire Lane
-  Office Trailers
-  Site Fence