



INTERCOLLEGIATE ATHLETICS BASKETBALL TRAINING FACILITY

PROJECT CONTACTS

Bob Dillon
Construction Project Manager
 Project Delivery Group
 bdillon@uw.edu | 206.423.5155



Sydney Thiel
Project Manager
 Project Delivery Group
 sydthiel@uw.edu | 206.960.2417



ABOUT THE PROJECT

- 36,000 sf (new facility) + 4,000 sf (interior renovation) = 40,000 sf total project
- 2 stories in height (approximately 40')
- Supports Men's and Women's Basketball programs
- Direct Connections to Hec Ed and Graves Annex for all athletes



CLICK OR SCAN TO LEARN MORE

SUMMARY OF UPCOMING ACTIVITIES (May 15 - June 30, 2024)

The project is continuing with underground utility install and the start of the Hec Ed band room remodel. As the project progresses, you will continue to see vac-trucks and excavators being used within the site and you will hear noise from drilling in the Hec Ed band space and the Graves Annex weight room. Additionally, at the end of May, initial selective demo will start within the Pool Pavilion with the main structural demo starting at the beginning of June and finishing at the beginning of July.

IMPACT BULLETIN

IMPACT TYPE	INFORMATION	IMPACT DATES
NOISE	<ul style="list-style-type: none"> • Graves Annex Steam Pipe Re-route • Hec Ed Band Room Remodel • Utility Installation • Pool Pavilion Demo 	<ul style="list-style-type: none"> • Mar 18 - May 30 • Apr 8- Aug 1 • Mar 18 - May 30 • May 31 - July 5
MINOR VIBRATION	<ul style="list-style-type: none"> • Sheet Piling Install for Storm Utility • Pool Pavilion Demo 	<ul style="list-style-type: none"> • May 15 - May 22 • May 31 - July 5
CLOSURES/TRANSPORT	<ul style="list-style-type: none"> • Pedestrian walk/bike path re-routed by Nordstrom • Steam Line Switchover • Hec Ed Break Room & Security Office (intermittently) 	<ul style="list-style-type: none"> • Mar 1 - Aug 2025 • May 29 • May 31 - July 5

UPCOMING MILESTONES





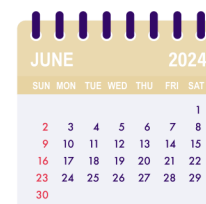

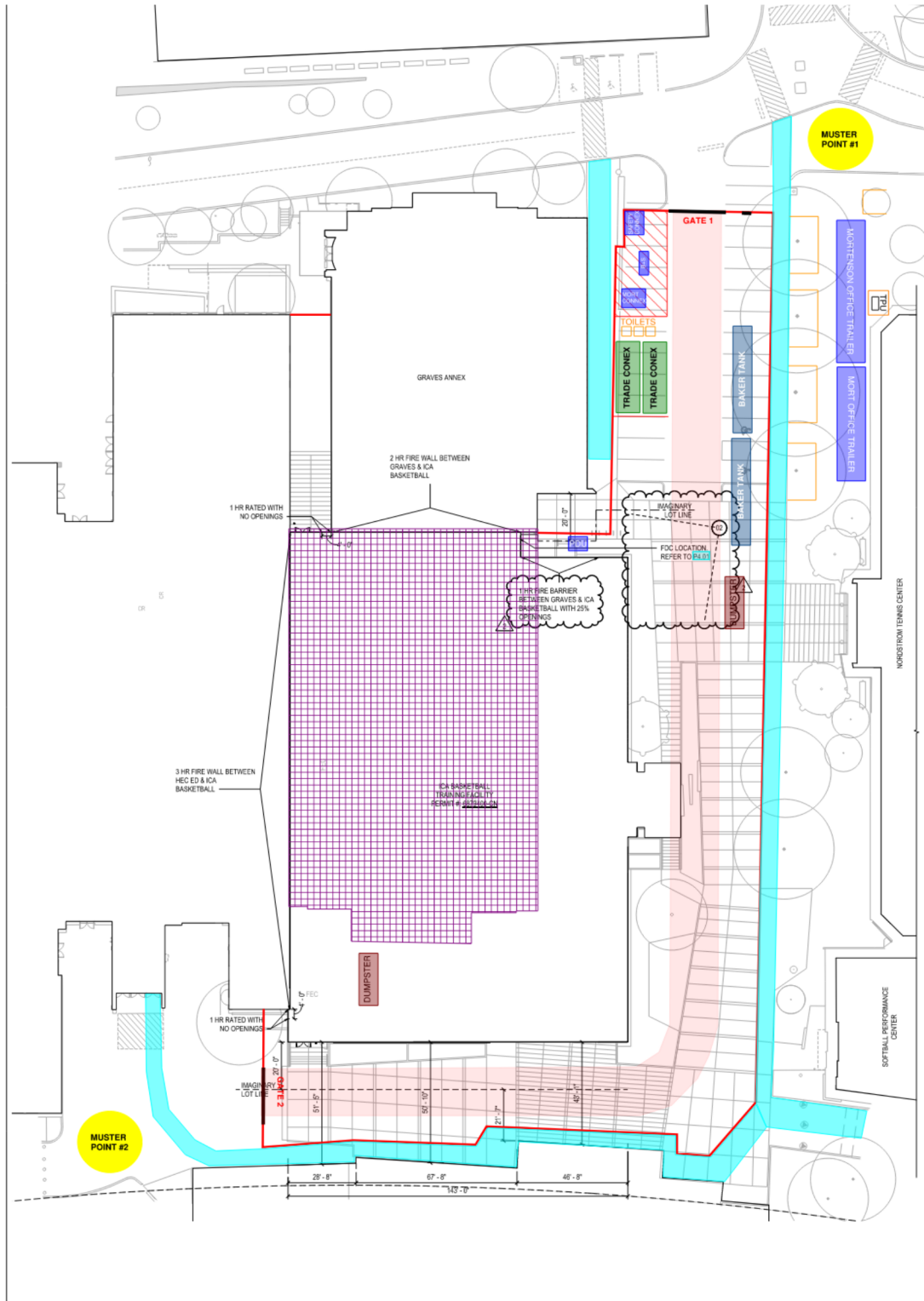

- *May 29: Steam Line Switchover*
- *May 31: Start of Pool Pavilion Selective Demo*



- *June 6: Structural Demo of Pool Pavilion Starts*



Site Logistics Legend

-  Existing Building Footprint
-  Pedestrian Walk Path
-  Bike Path
-  Fire Lane
-  Site Fence
-  Office Trailers