



INTERCOLLEGIATE ATHLETICS BASKETBALL TRAINING FACILITY

PROJECT CONTACTS

Bob Dillon
Construction Project Manager
 Project Delivery Group
 bdillon@uw.edu | 206.423.5155



Sydney Thiel
Project Manager
 Project Delivery Group
 sydthiel@uw.edu | 206.960.2417



ABOUT THE PROJECT

- 36,000 sf (new facility) + 4,000 sf (interior renovation) = 40,000 sf total project
- 2 stories in height (approximately 40')
- Supports Men's and Women's Basketball programs
- Direct Connections to Hec Ed and Graves Annex for all athletes



CLICK OR SCAN TO LEARN MORE

SUMMARY OF UPCOMING ACTIVITIES (April 15 - May 30, 2024)

The project is continuing with the installation of underground utilities and finishing up the abatement removal inside the Pavilion Pool building. As this works progresses, you can expect to see vac-trucks and excavators being used within the site as the utilities are being installed. Additionally, the band room remodel is starting up and the project team is getting ready for the start of the Pavilion Pool building demo, which happens at the end of May.

IMPACT BULLETIN

IMPACT TYPE	INFORMATION	IMPACT DATES
NOISE	<ul style="list-style-type: none"> • Graves Annex Steam Pipe Re-route • Hec Ed Steam Tunnel • Band Room Remodel • Vac trucking for Utilities • Demo of Pool Pavilion 	<ul style="list-style-type: none"> • Mar 18 - May 30 • Mar 8 - June 6 • Apr 08- Aug 1 • Mar 18 - May 30 • May 31 - July 5
ODOR	<ul style="list-style-type: none"> • Switchover of gas line 	<ul style="list-style-type: none"> • Apr 15 - Apr 19
CLOSURES/ TRANSPORT	<ul style="list-style-type: none"> • Pedestrian walk/bike path re-routed by Nordstrom • Power Line Switchover • Steam Line Switchover 	<ul style="list-style-type: none"> • Mar 1 - Aug 2025 • May 13 - May 17 • May 18 - May 20

UPCOMING MILESTONES

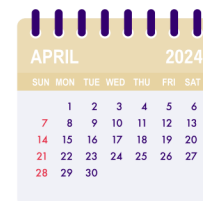



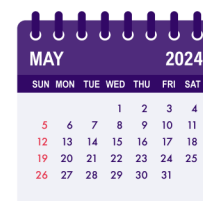

- *Apr 8-19: Band Room move-out*
- *Apr 22: Band Room Remodel Starts*
- *Apr 18: Gas Line Switchover*

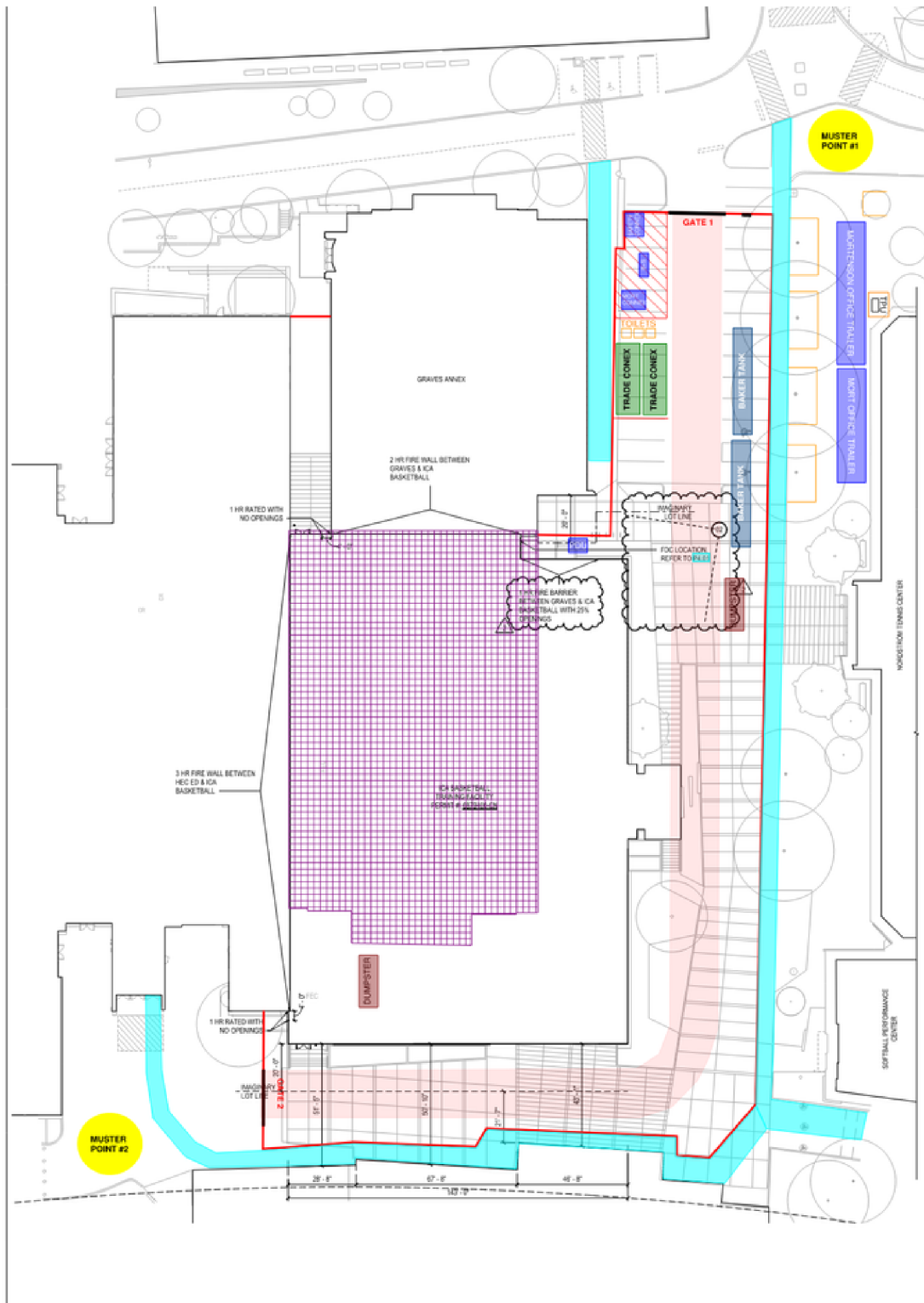

- *May 13-17 Power Line Switchover*
- *May 18-20: Steam Line Switchover*
- *May 31: Start of Pool Pavilion Demo*

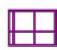

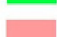
Site Logistics Legend

-  Existing Building Footprint
-  Pedestrian Walk Path
-  Bike Path
-  Fire Lane
-  Office Trailers
-  Site Fence